

## INSTRUCTION MANUAL

Save this manual for future reference

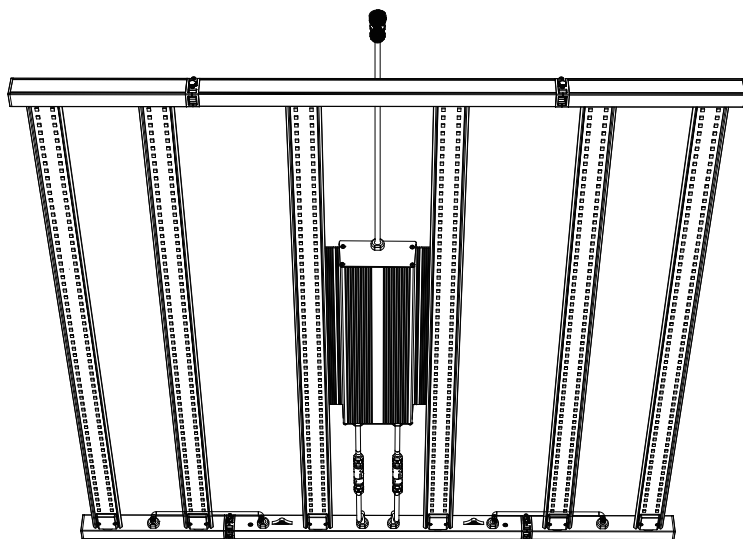

## Flora-C Series

## OVERVIEW

- With high efficacy of 2.6 $\mu$ mol/J
- Spectrum top-lighting solution for commercial horticulture cultivation
- Strategic diode placement increases uniformity of light delivery to canopy
- Provide more than 15% light to the plant canopy and save 35% less power while compared with 1000w HPS
- IP65 protect against water and dust
- 5 year warranty

## ELECTRICAL SPECIFICATION

Item Code	Model	Application	Enlite Flux ( $\mu$ mol/s)	Power (W)	$\mu$ mol/Joule	Dimming	IP	Weight	Voltage	Lifetime to L90
Flora-430-C	Flora-C	Vegetative	1075	430	2.6	0-10V	IP65	19.18lbs/ 8.7kg	110-277V	$\geq$ 50,000hr

## SPECTRA

FAMILY	MODEL	SPECTRUM	INPUT VOLTAGE
Flora-C	Flora-430-C	V4 Spectrum	Rated Voltage 110-277V AC

PRODUCT DIMENSION

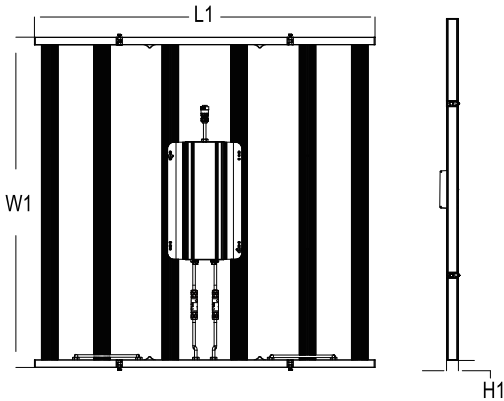

Model	L1(mm)	W1(mm)	H1(mm)
Flora-430-C	1070	1038	37

DIMMING CONNECTION DIAGRAM

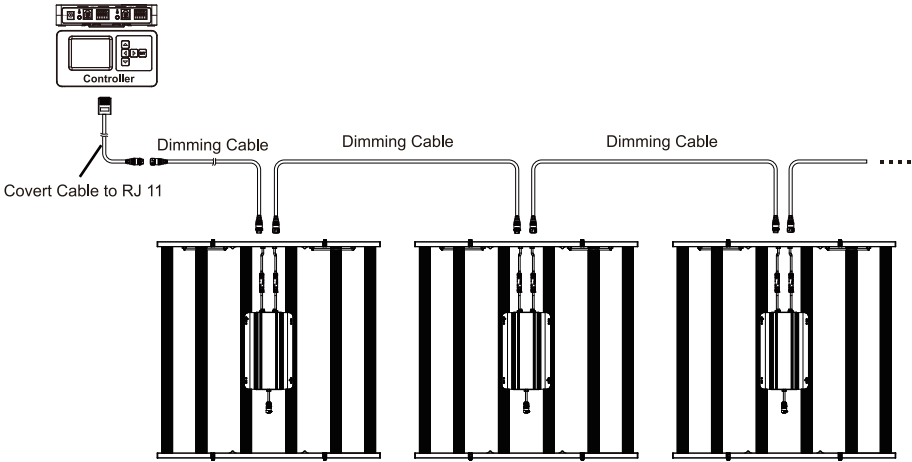

PARTS LIST

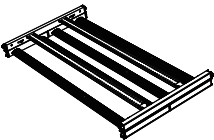

A

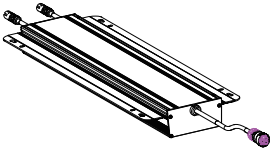

B



C









D

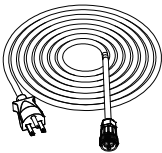

E

- A: Flora-C fixture
- B: Power Supply
- C: Dimming Cable (x1)
- D: Rope Ratchet (x2)
- E: Hanger (x2)

Power Cable (Optional)

	Type of Male	Item Code	Description
		PC100	10' FT Leads, Power cable
		PC105	10' FT 120V plug (5-15P), Power cable
		PC106	10' FT 240V plug (6-15P), Power cable
		PC107	10' FT 277V plug (L7-15P), Power cable
		PC108	10' FT 277V plug (L7-20P), Power cable

Signal Cable (Optional)

	Item Code	Description
	SC101	Covert Cable to RJ 11



**WARNING - POSSIBLE RISK OF INJURY TO EYES AND SKIN**  
Hazardous UV,HEV, and IR radiation may be emitted from light source. Always wearpersonal protective equipment ensuring complete shielding of skin and eyes.Avoidprolonged exposure and looking directly at light source.



## **WARNINGS**

---

### **READ THE FOLLOWING INSTRUCTIONS CAREFULLY BEFORE USING OR WORKING WITH THE PRODUCT**

- Best practices are to have a licensed electrician install your Lighting fixtures.
- Turn off the power and unplug fixture when you perform any maintenance or cleaning activity.
- Do not open or remove chassis covers or sheet-metal parts Such an action could cause severe electrical shock.
- Avoid hitting, bending or causing mechanical stress to the fixture.
- To ensure optimal performance, the back of the lighting panels may require periodic Cleaning. Clean with compressed air or damp lint free cloth.
- Always provide a well-ventilated environment where ambient temperatures do not exceed 45°C(113°F) regardless of whether the fixtures are in operation or off.
- Excessive temperatures can inhibit performance and may cause damage or shorten the life of the fixtures and void the warranty.
- Do not cover or block any part of the fixture during operation.
- Avoid high pressure jets of water to the fixture
- Avoid coiled cords and keep mains leads separated. This prevents electromagnetic interference.
- Ensure the existing electrical can support the voltage and current requirements of the LED fixture.
- Avoid touching uninsulated electrical wires or terminals that have not been disconnected from their power source. Such an action could cause electrical shock.
- Always ensure that all modules, power supplies, and cover panels are fully inserted and that the installation screws are fully tightened.
- Do not open or disassemble the LED fixture, it contains no serviceable parts inside. Opening or modifying the LED fixture can be dangerous and will void the warranty.
- Always allow for a cool down period of at least 30 minutes before touching the LED bars.



**WARNING! BE SURE TO MOUNT THE SYSTEM TO SOMETHING THAT CAN HOLD THE WEIGHT OF THE LED FIXTURE.**

## INSTALLATION

Before you start the installation, make sure to address the following:  
This fixture installation requires 2 people

### Step 1

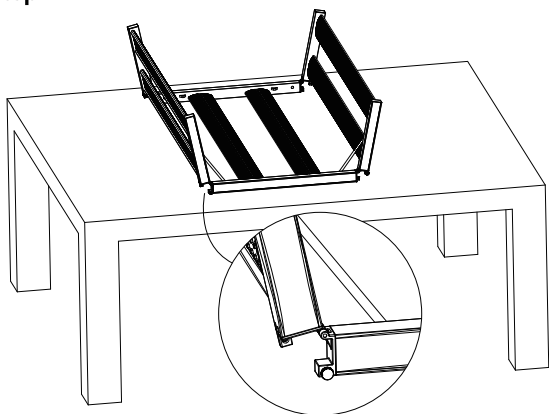

Unfold the light, Remove the protection paper board.

Unfold the light and pull the spring screws on both end together ensure the light is fully extended

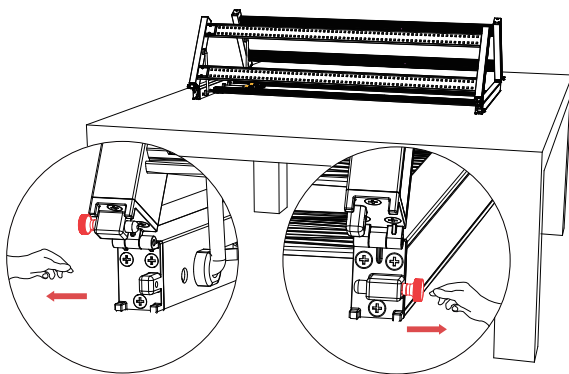

### Step 2

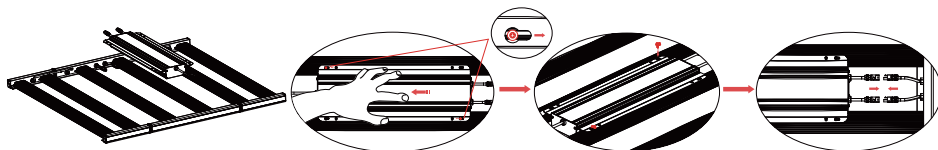

Place the driver onto the radiator screw. Push the driver toward the smaller end of the position.  
Screw in two screws. Connect it to the power cable.

# INSTALLATION

## Step 3

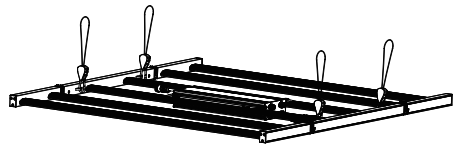

### Mounting Option A

To mount the Flora-C using hanger, Slide the hanger into the inside hole. Once both hangers are in place, using the Rope Ratchet to mount the light. Be sure to hang from the center of hanger, ensure a balanced fixture.

### Mounting OptionB

There are four lancet openings inside of the Flora-C light. Using Rope Ratchet to mount the light.

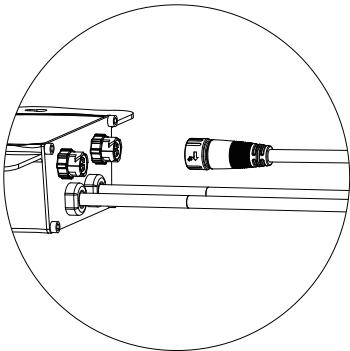
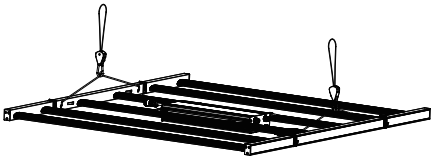

Connect the dimming wire and the power core together, and twist it until it's tight.

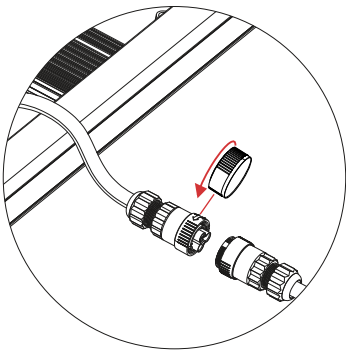

Connect the light with power source  
Turn the knob to the bottom.



## LIMITED WARRANTY

Enlite warrants the mechanical and electronic components of this LED product and guarantees the materials and workmanship free of defects, if used under normal operating conditions within a period of five (5) years from the purchase date. Misuse, abuse, or failure to follow instructions is not covered under this warranty. All returns and claims must be presented with the original proof of purchase.

Thank you for choosing Enlite LED Lighting. For further information about Enlite products, videos and technical information, please visit **[www.enlitehorti.com](http://www.enlitehorti.com)**.